

## SLG FLOW INDICATOR Dimensions

### Applications

The SLG Flow Indicator is a compact double window design, suitable for a wide range of applications in high purity tubing systems and may be installed in any position to observe fluid flow.

This feature ensures that the sight glasses are free-draining and avoids the possibility of fluid retention.

The sight flow indicator is usually employed to detect either the presence or absence of solutions, or to observe fluid for turbulence, colour or clarity. The SLG Flow Indicator are ideal for high purity applications.

### Advantages :

- Can be cleaned in situ - SIP / CIP
- Sterilizable – Autoclavable
- Full bore flow path
- Compact design with large viewing area
- Stress, Crack and shatter resistant
- High temperature and pressure resistant
- Meets FDA specifications
- Full material traceability

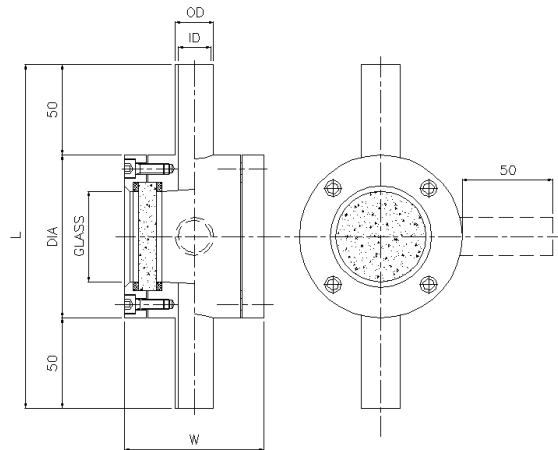

dimensions table

CODE 2V	BS Ø		L	W	DIA	Glass	Borosilicate OD	glass Thk	P max	T max	DIN Ø	
	OD	ID									OD	ID
SLG-200BGBG..-G-11A	12,7	9,4	190	75	90	50	60	10	16 bar	250°C	/	/
SLG-200BHBH..-G-11A	19,05	15,75	190	75	90	50	60	10	16 bar	250°C	/	/
SLG-200BJBJ..-G-11A	25,4	22,1	190	75	90	50	60	10	16 bar	250°C	/	/
SLG-300BMBM..-G-11A	38,1	34,8	240	120	130	85	100	15	16 bar	250°C	/	/
SLG-300BNBN..-G-11A	50,8	47,5	240	120	130	85	100	15	16 bar	250°C	52	47
SLG-300BOBO..-G-11A	63,5	60,2	240	150	130	85	100	15	16 bar	250°C	70	66
SLG-300BPBP..-G-11A	76,1	72,9	240	150	130	85	100	15	16 bar	250°C	85	81
SLG-300BRBR..-G-11A	101,6	97,4	240	180	130	85	100	15	16 bar	250°C	104	100
SLG-500FTFT..-G-11A	/	/	280	212	180	125	150	20	10 bar	250°C	129	125

### Operating Conditions:

Design Pressure up to 16 bar  
Design Temperature up to 250 °C

### Material:

body housing AISI 316L stainless steel  
ends connections AISI 316L stainless steel  
locking ring AISI 316L stainless steel  
bolts AISI 304 stainless steel  
insert material Borosilicate tempered glass to DIN 7080  
gaskets TFM PTFE

### Surface finish:

SLG product contact surface are finish with Ra<0,5 micron or better

### Marking:

Each SLG Sanitary Flow Indicator is marked with code, material and serial number for full lot traceability



**Get the information you need and more at : [info@aerinox.it](mailto:info@aerinox.it)**

In the interests of development and improvement of the product, we reserve the right to change the specifications without prior notice.

**Aerre Inox s.r.l.**

26010 FIESCO Via Gerola n.4 -CREMONA- Italy  
Tel. +39.0374.370828 Fax +39.0374.370833  
e-mail : [info@aerinox.it](mailto:info@aerinox.it) http : [www.aerinox.it](http://www.aerinox.it)